



5th Gear

Installation

NOTE: Replace all locknuts and spring pins.

1. Reassemble the parts following the numbered sequence.

	Bolt Size	Torque Value	
A	6 x 1.0 mm	12 N·m (1.2 kg-m, 9 lb-ft)	(20)

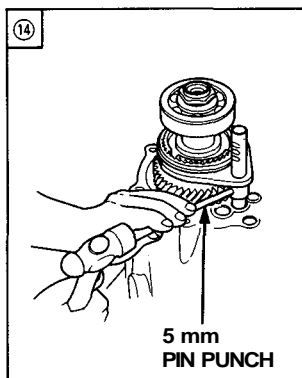
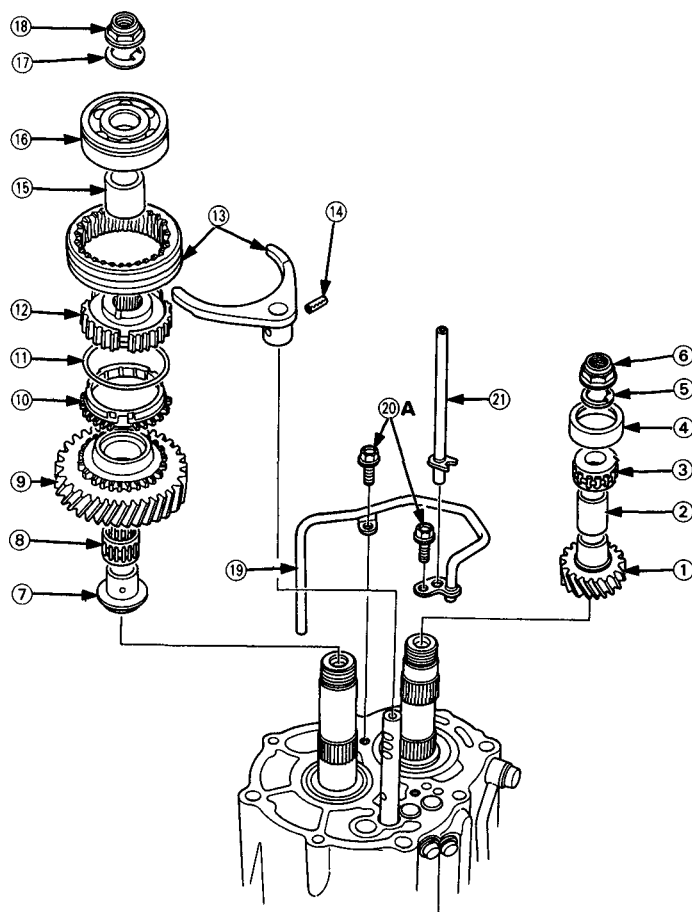

(6) (18)

- 1. Install the mainshaft holder.

MAINSHAFT HOLDER
07924-PJ4010A

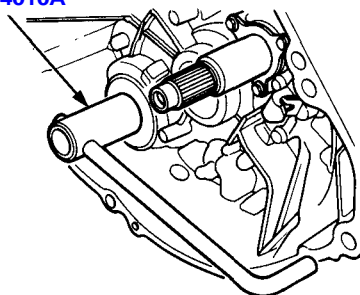

- 2. Tighten the locknut, then stake the locknut tab into the groove.
NOTE: Countershaft locknut has left-hand threads.

LOCKNUT

160 → 0 → 160 N·m

(16 → 0 → 16 kg-m, 116 → 0 → 116 lb-ft)

LOCKNUT

SPRING WASHER

